

LIST OF WORKS

Main Gallery

All works by Rashid Johnson

1. *House Arrest*, 2012, branded red oak flooring, black soap, wax, 215.3 × 154.3 × 6.4 cm

2. *Genius*, 2012, black mirrored tile, black soap, wax, 184.8 × 124.5 × 7.6 cm

3. *Cosmic Slop "Independence"*, 2012, black soap, wax, 229.9 × 337.2 × 7.6 cm

4. *Death in Outer Space*, 2012, canvas, spray, enamel, 106.7 × 127 × 3.8 cm

5. *The New Negro Escapist Social and Athletic Club (Kiss)*, 2011, silver gelatin print, 101.6 × 76.2 cm

6. *Cosmic Slop "Conference"*, 2012, black soap, wax, 199.4 × 138.4 × 7.6 cm

7. *The End of Anger*, 2012, mirrored tile, black soap, wax, books, oyster shells, shea butter, vinyl, 123.2 × 214.6 × 45.7 cm

8. *National Election*, 2012, burned red oak flooring, black soap, wax, 229.9 × 337.2 × 7.6 cm

9. *Cosmic Slop "Unrest"*, 2012, black soap, wax, 123.2 × 123.2 × 7.6 cm

10. *Untitled (daybed 1–4)*, 2012, burned red oak, burned red oak flooring, black soap, wax, zebra skin cushions, 64.1 × 185.4 × 91.4 cm

First Floor Galleries

1. Angel Otero, *Untitled*, 2012, oil paint on oil paint skins collaged on canvas, 104 × 84 × 7.5 cm

2. Sam Gilliam, *Half Circle Cape 1 (gray)*, 1972, acrylic on canvas, 185.5 × 75 × 21.5 cm
Courtesy David Kordansky Gallery, Los Angeles, CA

3. Robert Davis, *Coffee and Cigarettes*, 2012, coffee and cigarettes on canvas sprayed with PVA, 30.5 × 35.6 cm

4. Angel Otero, *Untitled*, 2012, oil paint skins collaged on canvas, 71 × 61 × 7.5 cm

5. Robert Davis, *Ghost Face*, 2012, oil on burlap, 101.6 × 101.6 cm

6. Robert Davis, *Wine No. 1 (Cabernet)*, 2012, wine (Cabernet) on canvas sprayed with PVA, 121.9 × 91.4 cm

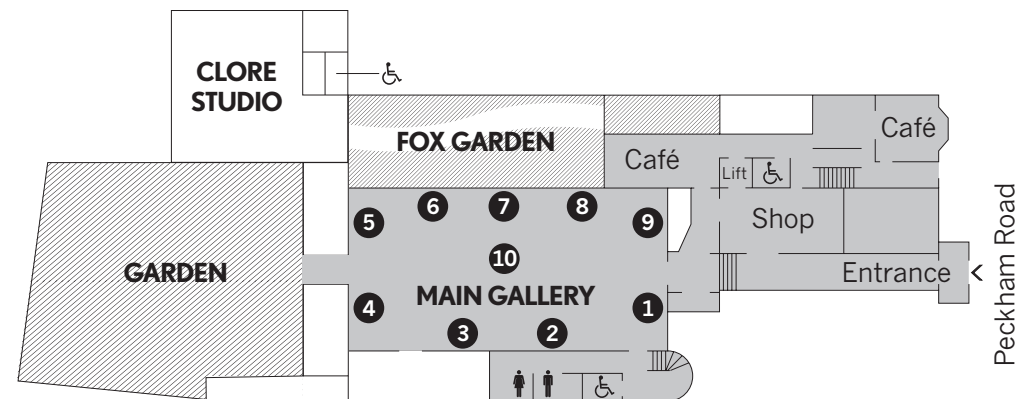

SLG
GROUND FLOOR

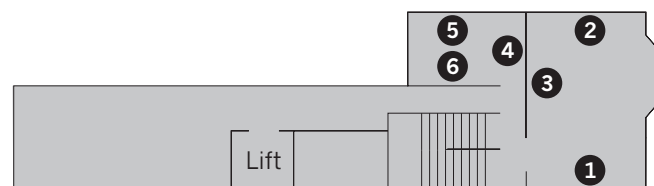

SLG
FIRST FLOOR GALLERIES

RASHID JOHNSON: SHELTER

EXHIBITION GUIDE
SOUTH LONDON GALLERY
28 SEP – 25 NOV 2012

RASHID JOHNSON: SHELTER 28 SEP – 25 NOV 2012

South London Gallery
Admission free

Main Gallery

For his first solo exhibition in London, Chicago-born, New York-based artist Rashid Johnson presents an entirely new body of work to create an immersive environment in the South London Gallery's main space. Over the past decade Johnson has become known for works into which he integrates materials familiar from other contexts, such as wooden flooring, rugs, mirrors, shelves, books and shea butter, through a process which he describes as 'hijacking the domestic'. Questioning established definitions of the art object and its limitations, or otherwise, Johnson's works also draw on his own personal history, often making direct references to the literature, music, cultural and political figures which inform it, in an ongoing exploration of the relationship between individual and shared cultural experience.

Entitled *Shelter*, Johnson's South London Gallery exhibition takes as its starting point an imagined society in which psychotherapy is a freely available drop-in service, accessible to all through group sessions. He introduces the potential of such a scenario through a line of four

zebra skin-covered wooden day beds, each one very specifically positioned on a Persian rug. At odds with their potential as places of repose, three of the beds are turned on their sides to reveal traces of at times aggressive manipulation by the artist in the form of paint pours and spills, scratches and gouges. In some respects this is a soothing place, where the carpets, greenery and ceiling lantern lend notes of comfort and calm to a space in which the day beds might otherwise encourage self-reflection, as well as providing vantage points from which to view the wall-mounted works. The blackened, gouged, branded and splintered surfaces of the surrounding paintings, however, hint at a darker frame of mind and the hidden depths of the individual and collective psyche. Together they take Johnson's enquiry into the nature and possibilities of painting, and the creative potential of reductive processes, several steps further.

In many of his works Johnson shifts familiar materials from one arena into another, testing assumptions about those materials, and also about the nature of art. Sections of parquet flooring take the place of canvas; mirrors are fractured and blackened to become the stuff of abstract paintings, shot through with figuration in the form of viewers' reflections; and Persian rugs, objects of extraordinary beauty but firmly located within the

canon of craftsmanship and design rather than fine art, take on a new and ambiguous status in the context of the contemporary art gallery. Here the rugs are suggestive of cultural 'otherness', referring to the Western history of romanticising notions of 'the oriental', whereas Johnson's covering of the branded wooden day beds in zebra skins was a deliberate move to cite ideas of 'the exotic' by shrouding items of furniture loaded with associations of Western privilege in a material with distinctively African associations. Inspired in part by Johnson's musing on what kind of day bed a post-colonial African leader might recline on, having recently read a book about former Congolese Prime Minister, Patrice Lumumba, the day beds typify Johnson's capacity to mine and merge multiple sources to create something new with its own distinctive voice.

First Floor Galleries

Invited to curate the exhibition in the SLG's first floor galleries, Johnson decided to bring together works by three abstract painters whose work has informed his own and with whom he has ongoing dialogues about his and their practices. Entitled *Drip, Drape, Draft*, the show presents works by Robert Davis, a close friend of Johnson for more than a decade; Angel Otero, who he has known for some six years; and Sam Gilliam, an

older artist from what Johnson refers to as 'an almost lost generation of black abstract painters', with whom he recently struck up a mutually significant friendship.

www.southlondongallery.org/rashidjohnson

With thanks to Hauser & Wirth and David Kordansky Gallery, Los Angeles, CA.

Catalogue

A catalogue accompanies the exhibition and will be available from the SLG shop from 11 October. Please contact the shop to reserve a copy: 020 7703 6120.

Exhibition reading list

A selection of publications chosen by the SLG shop to accompany the exhibition are available to purchase in the shop: www.southlondongallery.org/shop

RELATED EVENTS

Exhibition Tours

Every Sat, 3pm, & Last Fridays, 7pm, Free
Gallery assistants lead informal drop-in tours of the exhibition.

The Sunday Spot

Sun 7 Oct, 4 & 25 Nov, 2-4pm, Free
Explore our current exhibition by Rashid Johnson at artist-led workshops.
All welcome, ideal for children aged 3-12 years.

Forthcoming Exhibitions

Sanja Iveković
South London Gallery & Calvert 22
14 Dec 2012 – 24 Feb 2013

Pauline Boudry and Renate Lorenz
14 Dec 2012 – 24 Feb 2013

Pae White
15 Mar – 12 May 2013

SLG

South London Gallery 65–67 Peckham Road, London SE5 8UH
020 7703 6120 mail@southlondongallery.org www.southlondongallery.org
Twitter: @SLG_artupdates



Supported using public funding by
ARTS COUNCIL ENGLAND



outset.